

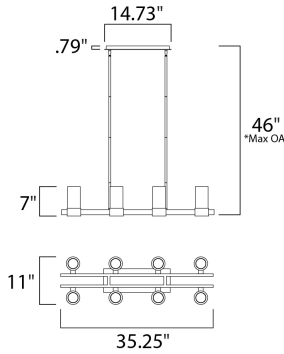

PRODUCT DESCRIPTION

The Silo collection makes artful use of thin-profile rectangular tubing with a mirror-like Polished Chrome finish for a clean, contemporary look. A subtle Frost on the underside of the two cylindrical glass shades adds softness to the sleek lines, while the bright Xenon lamps are cleverly concealed in the cast metal ring allowing ample light to cast both upwards and downwards without glare.



*max overall height

MEASUREMENTS

- DIMENSION : 35.25" L x 11" W x 7" H
- MAX OAH : 46" OAH
- CANOPY : 4.33" W x 0.79" H x 14.73" L
- HANGING WEIGHT : 17.6 lb

LAMPING

- INPUT VOLTAGE : 120V
- LUMENS : 3,600 Rated (3,200 Del.)
- BULB : 8 x 40W Xenon G9 , 320W Total
- BULB INCLUDED : (Included)
- DIMMABLE : Yes
- COLOR_TEMP : 2900K

FINISHES OPTION

- Polished Chrome (PC)

GLASS

Clear and Frosted CLFT

MATERIAL

Metal, Glass

RATINGS

cETLus
Dry Location



ADDITIONAL

ADJUSTABLE
SLOPE: 120
RATED LIFE 2000 Hours
OPERATING TEMPERATURE:
-20°C (-4°F), 40°C (104°F)

Always consult a qualified electrician before installing any lighting product.



WESTERN DISTRIBUTION CENTER (HEADQUARTER)
253 NORTH VINELAND AVE | CITY OF INDUSTRY, CA 91746

EASTERN DISTRIBUTION CENTER
101 GARDNER PARK | PEACHTREE CITY, GA 30269

P. 626.956.4200 | F. 626.956.4225 | maximlighting.com