

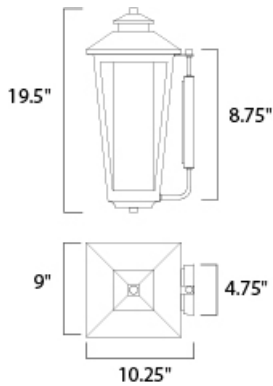

**PRODUCT DESCRIPTION**

A slender profile traditional frame finished in Artesian Bronze with Clear glass outer pane with a Frost interior cylinder diffuser. Upscale styling at price that won't kill your budget.



**MEASUREMENTS**

DIMENSION : 9" W x 19.5" H x 10.25" Ext  
 BACK PLATE : 4.75" W x 8.75" H x 11" HCO  
 HANGING WEIGHT : 8.36 lb

**LAMPING**

INPUT VOLTAGE : 120V  
 BULB : 1 x 60W Incandescent E26 Medium , 60W Total  
 BULB INCLUDED : (Not Included)  
 DIMMABLE : Yes

**FINISHES OPTION**

 Artesian Bronze (AT)

**GLASS**

Clear and Frosted CLFT

**MATERIAL**

Aluminum, Glass

**RATINGS**

cETLus  
 Wet Location



**ADDITIONAL**

OPERATING TEMPERATURE:  
 -20°C (-4°F), 40°C (104°F)

Always consult a qualified electrician before installing any lighting product.



WESTERN DISTRIBUTION CENTER (HEADQUARTER)  
 253 NORTH VINELAND AVE | CITY OF INDUSTRY, CA 91746

EASTERN DISTRIBUTION CENTER  
 101 GARDNER PARK | PEACHTREE CITY, GA 30269

P. 626.956.4200 | F. 626.956.4225 | maximlighting.com