

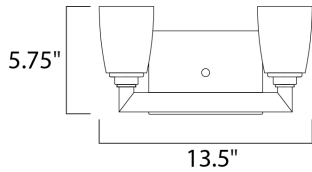

PRODUCT DESCRIPTION

Rectangular metal tubing mitered to a perfect angle lends a sharp, clean, contemporary look. Angle collection utilizes xenon lamps for ultimate light output while maintaining a petite scale and low profile. Angle is available in Satin Nickel finish with Satin White glass.



MEASUREMENTS



DIMENSION : 13.5" W x 5.75" H x 4" Ext
 BACK PLATE : 4.25" W x 5.75" H
 HANGING WEIGHT : 3.09 lb

LAMPING

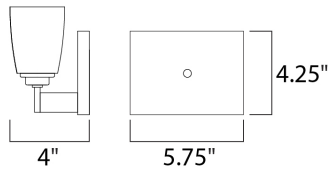
INPUT VOLTAGE : 120V
 LUMENS : 900 Rated
 BULB : 2 x 40W Xenon G9 , 80W Total
 BULB INCLUDED : (Included)
 DIMMABLE : Yes
 COLOR_TEMP : 2900K



FINISHES OPTION

-  Oil Rubbed Bronze
-  Satin Nickel

GLASS

Satin White SW

MATERIAL

Steel

RATINGS

Damp Location
 ADA



ADDITIONAL

INSTALL UP/DOWN: Up
 RATED LIFE 2000 Hours
 OPERATING TEMPERATURE:
 -20°C (-4°F), 40°C (104°F)

Always consult a qualified electrician before installing any lighting product.



WESTERN DISTRIBUTION CENTER (HEADQUARTER)
 253 NORTH VINELAND AVE | CITY OF INDUSTRY, CA 91746

EASTERN DISTRIBUTION CENTER
 4200 SHIRLEY DR. | ATLANTA, GA 30336

P. 626.956.4200 | F. 626.956.4225 | maximlighting.com