



**PRODUCT DESCRIPTION**

Cone shaped Satin White cased glass shades are supported by simplistic yet elegant frames of your choice of Satin Nickel or Polished Chrome. Although these vanities are illuminated by high power integrated LED, they are priced for most budgets.

**MEASUREMENTS**

DIMENSION : 16.5" W x 5.25" H x 9.25" Ext  
 BACK PLATE : 7.13" W x 4.75" H x 3.25" HCO  
 HANGING WEIGHT : 4.35 lb

**LAMPING**

LUMENS : 1,500 Rated  
 BULB : 2 x 9.5W LED PCB , 19W Total  
 BULB INCLUDED : (Integrated)  
 DIMMABLE : Triac  
 CRI : 90+ CRI  
 COLOR\_TEMP : 3000K

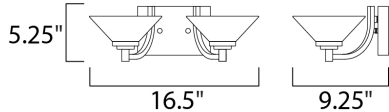

**FINISHES OPTION**

-  Polished Chrome
-  Satin Nickel

**GLASS**

Satin White SW

**MATERIAL**

Metal

**RATINGS**

Damp Location



**ADDITIONAL**

OPERATING TEMPERATURE:  
 -20°C (-4°F), 40°C (104°F)

Always consult a qualified electrician before installing any lighting product.



**WESTERN DISTRIBUTION CENTER (HEADQUARTER)**  
 253 NORTH VINELAND AVE | CITY OF INDUSTRY, CA 91746

**EASTERN DISTRIBUTION CENTER**  
 4200 SHIRLEY DR. | ATLANTA, GA 30336

P. 626.956.4200 | F. 626.956.4225 | maximlighting.com