

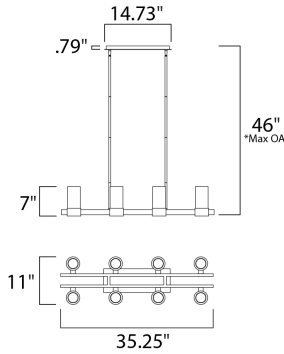

**PRODUCT DESCRIPTION**

The Silo collection makes artful use of thin-profile rectangular tubing with a mirror-like Polished Chrome finish for a clean, contemporary look. A subtle Frost on the underside of the two cylindrical glass shades adds softness to the sleek lines, while the bright Xenon lamps are cleverly concealed in the cast metal ring allowing ample light to cast both upwards and downwards without glare.



\*max overall height

**MEASUREMENTS**

DIMENSION : 35.25" L x 11" W x 7" H  
 MAX OAH : 46" OAH  
 CANOPY : 4.33" W x 0.79" H x 14.73" L  
 HANGING WEIGHT : 17.6 lb

**LAMPING**

INPUT VOLTAGE : 120V  
 LUMENS : 3,600 Rated (3,200 Del.)  
 BULB : 8 x 40W Xenon G9 , 320W Total  
 BULB INCLUDED : (Included)  
 DIMMABLE : Yes  
 COLOR\_TEMP : 2900K

**FINISHES OPTION**

 Polished Chrome (PC)

**GLASS**

Clear and Frosted CLFT

**MATERIAL**

Metal, Glass

**RATINGS**

cETLus  
 Dry Location



**ADDITIONAL**

ADJUSTABLE  
 SLOPE: 120  
 RATED LIFE 2000 Hours  
 OPERATING TEMPERATURE:  
 -20°C (-4°F), 40°C (104°F)

Always consult a qualified electrician before installing any lighting product.



WESTERN DISTRIBUTION CENTER (HEADQUARTER)  
 253 NORTH VINELAND AVE | CITY OF INDUSTRY, CA 91746

EASTERN DISTRIBUTION CENTER  
 101 GARDNER PARK | PEACHTREE CITY, GA 30269

P. 626.956.4200 | F. 626.956.4225 | maximlighting.com